



THE BLACK MOUNTAIN

See Reverse Side
for Floor Plans

- 1 story on an unfinished basement with 3 bedrooms/2 bathrooms
- 2,016 heated square feet, 3,064 unheated square feet
- An optional finished basement adds 2 bedrooms, bath, family room, and 1,480 heated square feet
- Covered porches
- Open deck
- 8x6 D logs on main level with a 30 Year Manufacturer Warranty
- Log siding or board and batten on gable end walls
- Optional stacked stone on foundation
- Vaulted ceilings
- Ventless gas fireplace
- Many interior finishing options are available

Look out the window or step out onto the porch to enjoy Pisgah Preserve's many stunning views ...

PRESERVATION IS YOUR PERMANENT NEIGHBOR



©2008 Pisgah Preserve

The Black Mountain - updated 9/5/08



Pisgah Preserve
AT LAKE JAMES

Post Office Box 9148 • Morganton, NC 28680

828-448-1473 phone • Email: info@pisgahpreserve.com • www.pisgahpreserve.com

1st Floor Plan

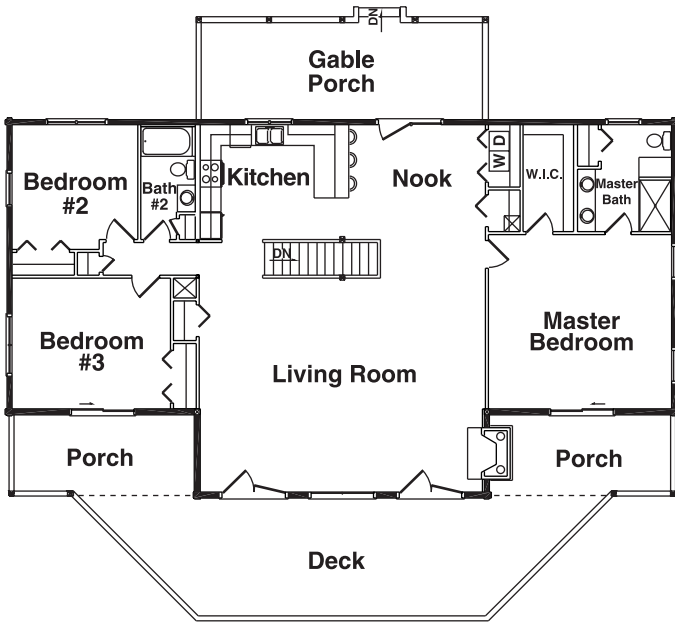

Optional Basement Floor Plan

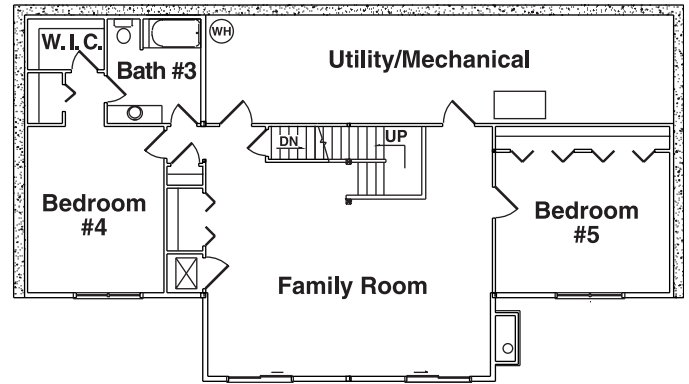

THE BLACK MOUNTAIN

Square Foot Totals

Main Floor = 2,016 ft²

Optional Basement = 1,480 ft²

Total Heated ft² = 3,496 ft²

Unfinished Basement = 536 ft²

Deck = 480 ft²

Porch = 288 ft²

Gable Porch = 280 ft²

Total Unheated ft² = 1,594 ft²